

THE SCHOOL

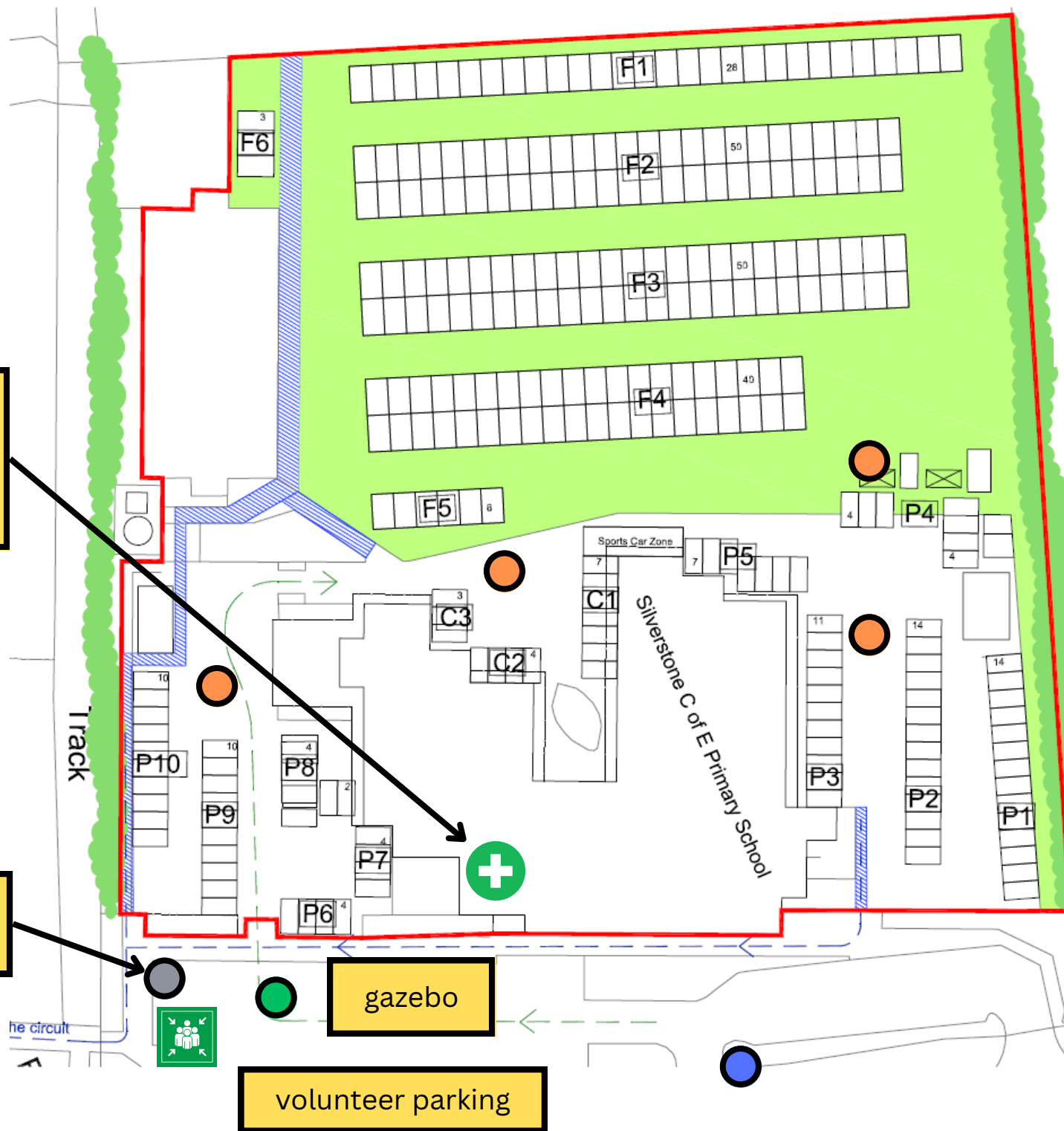

- ENTRANCE TEAM
- SCANNING TEAM
- PEDESTRIAN & TRAFFIC TEAM

volunteer refreshments and toilets inside building

customer portaloos

gazebo

volunteer parking

The site plan for Silverstone C of E Primary School shows a large green area for playgrounds (F1-F5) and a parking area (P1-P10). The school buildings (C1-C3) are located in the center. A red boundary line surrounds the entire site. A blue dashed line indicates a proposed route. Various traffic signs are shown, including pedestrian crossings, 5 MPH speed limits, and a 'No Entry' sign. A green cross symbol is also present.

5 MPH
Pedestrian pathways